

Fw 190A-8

eduard

1/72 SCALE PLASTIC KIT

ProfiPACK
edition

#70111



intro

The second half of the Second World War saw the Focke-Wulf Fw 190, in its various forms, emerge as the best of what was available to the Luftwaffe. The dedicated fighter version was a high performance, heavily armed machine. Its development had a precarious beginning, against a 1938 specification issued by the Technisches Amt, RLM. The first prototype took to the air on June 1st, 1939. After a series of improvements and even radical changes, the design culminated in the fall of 1940 in the pre-series version Fw 190A-0 to the tune of twenty-eight pieces. Six of these were retained by the test unit Erprobungsstaffel 190 at Rechlin, which was tasked with conducting service trials. These revealed a wide range of flaws to the point where the RLM halted further development. Despite this, on the basis of urgings from the test unit staff, the aircraft was not shelved. After a series of some fifty modifications, the RLM gave the go ahead for the Fw 190 to be taken into inventory of the Luftwaffe. In June 1941 the Luftwaffe accepted the first of 100 ordered Fw 190A-1s, armed with four 7.9 mm MG 17s. By September 1941, II./JG 26 was completely equipped with the type, operating on the Western Front. November saw the production of the next version Fw 190A-2, powered by a BMW 801C-2, and armed with two 7.9 mm MG 17s and two MG 151s of 20 mm caliber in the wings. Part of this series received an additional pair of 20 mm MG FFs, thus attaining an armament standard of later types. A significant advancement to the design came in the spring of 1942, when the BMW 801D-2 became available, whose installation gave birth to the Fw 190A-3. July saw the development of the improved A-4. Both were armed with what became the standard two fuselage mounted MG 17s, two wing mounted MG 151 cannon, and two MG FF cannon, placed inboard of the wheel wells. During 1942 production had intensified, and a production facility was set up under license at Fieseler. Thanks in part to this, production rose in 1942 to 1,878 units as opposed to 224 in 1941. Large-scale production of the A-5 was initiated in April 1943, with an identical wing to the A-4, but with a nose extension that would become standard on all subsequent Fw-190A versions up to the A-9, and also on the corresponding F types. July saw the development of a new, strengthened wing, which incorporated MG 151s instead of the MG FFs in the outer position. The adoption of this wing developed the A-6 version. Further changes developed the A-7, produced during the end of 1943. This version came about with the replacement of the fuselage mounted MG 17s with 13 mm MG 131s. Further improvements led to the Fw 190A-8, and this version became the most widely produced with some 1,400 units made. The most significant change to this variant was the installation of the GM-1 nitrous-oxide injection system, for temporary power boost in combat. A portion of A-8 production was built as the A-8/R2 and A-8/R8, armed with MK 108 cannon in the outer wing location, and with armoured slabs added to the cockpit sides and a modified canopy. The final production version of the BMW 801 powered fighter was the Fw 190A-9, equipped with the BMW 801TS of 2000 hp (1470 kW). There was a parallel development of these fighter optimized aircraft with a dedicated fighter-bomber version, the Fw 190F. These aircraft had reduced wing armament to two MG 151 cannon in the wingroot position. The engine was optimized for low level operation and the armament options varied to satisfy the ground attack role, including bombs of various weight classes and a variety of anti-tank rockets. This branched into the extended range Fw 190G version. Development of the thoroughbred fighter continued in the guise of the Fw 190D, which began to reach Luftwaffe units in the second half of 1944, and was the result of mounting an in-line Jumo 213A-1 engine into a modified Fw 190A-8 airframe. Although the Fw 190 never achieved the widespread usage of the competing Bf 109, its contribution to the German Air Force was certainly significant through the second half of WWII. Fw 190s saw service on the Western Front as well as in the East. As heavy fighters with imposing firepower, they found themselves integral components, from 1943 onwards, within the units tasked with the protection of the Reich from the ominous clouds of allied four-engine bombers. This is where the A-8 version was instrumental, along with its A-8/R2 armoured development. This version, with its firepower, was a very ominous and daunting foe for the bomber crews. From the second half of 1944, their danger was kept in check to a degree by escorting P-47s, and necessitated the development of the P-51 Mustang.

70111 - NAV1



Carefully read instruction sheet before assembling. When you use glue or paint, do not use near open flame and use in well ventilated room. Keep out of reach of small children. Children must not be allowed to suck any part, or pull vinyl bag over the head.



Před započatím stavby si pečlivě prostudujte stavební návod. Při používání barev a lepidel pracujte v dobře větrané místnosti. Lepidla ani barvy nepoužívejte v blízkosti otevřeného ohně. Model není určen malým dětem, mohlo by dojít k požití drobných dílů.



OPTIONAL
VOLBA



BEND
OHNOUT



OPEN HOLE
VYVRTAT OTVOR



SYMETRICAL ASSEMBLY
SYMETRICKÁ MONTÁŽ



REMOVE
ODŘÍZNOUT



REVERSE SIDE
OTOČIT



APPLY EDUARD MASK
AND PAINT
POUŽIT EDUARD MASK
NABARVIT



PLASTIC PARTS

A>

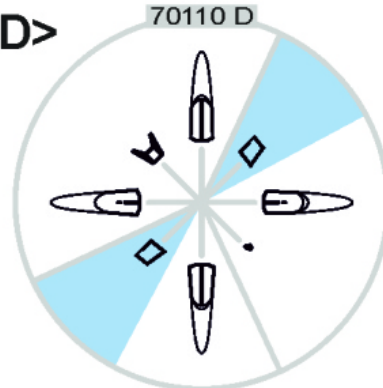
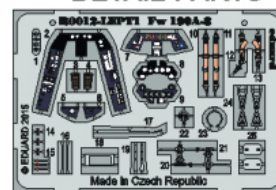

D>

PE - PHOTO ETCHED
DETAIL PARTSeduard
MASK

C>

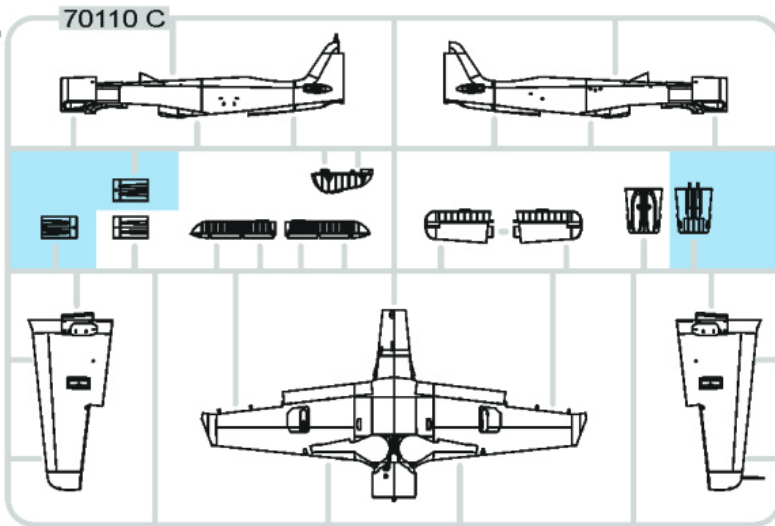

-Parts not for use. -Teile werden nicht verwendet. -Pièces à ne pas utiliser. -Tyto díly nepoužívejte při stavbě. - 使用しない部品



| GSI Creos (GUNZE) | | MISSION MODELS | |
|-------------------|----------|----------------|-------------------|
| AQUEOUS | Mr.COLOR | PAINTS | |
| H1 | C1 | MMP-001 | WHITE |
| H2 | C2 | MMP-047 | BLACK |
| H11 | C62 | MMP-001 | FLAT WHITE |
| H12 | C33 | MMP-047 | FLAT BLACK |
| H25 | C34 | | SKY BLUE |
| H33 | C81 | | RUSSET |
| H47 | C41 | MMP-012 | RED BROWN |
| H65 | C18 | MMP-088 | RLM70 BLACK GREEN |
| H68 | C36 | MMP-049 | RLM74 DARK GRAY |
| H69 | C37 | MMP-050 | RLM75 GRAY |
| H70 | C60 | MMP-056 | RLM02 GRAY |
| H77 | C137 | MMP-040 | TIRE BLACK |
| H80 | C54 | | KHAKI GREEN |
| H90 | C47 | | CLEAR RED |

| GSI Creos (GUNZE) | | MISSION MODELS | |
|-------------------------|----------|----------------|--------------------|
| AQUEOUS | Mr.COLOR | PAINTS | |
| H94 | C138 | | CLEAR GREEN |
| H413 | C113 | MMP-090 | RLM04 YELLOW |
| H414 | C114 | | RLM23 RED |
| H416 | C116 | MMP-089 | RLM66 BLACK GRAY |
| H417 | C117 | MMP-051 | RLM76 LIGHT BLUE |
| H421 | C121 | MMP-052 | RLM81 BROWN VIOLET |
| H422 | C122 | MMP-053 | RLM82 LIGHT GREEN |
| H423 | C123 | MMP-054 | RLM83 DARK GREEN |
| Mr.METAL COLOR | | METALLICS | |
| MC213 | | MMM-006 | STEEL |
| MC214 | | MMM-001 | DARK IRON |
| Mr.COLOR SUPER METALLIC | | METALLICS | |
| SM01 | | MMC-001 | SUPER CHROME |

**IF YOU USE PARTS PE2 AND PE7,
THEN YOU MUST USE PARTS A7 AND A8.**

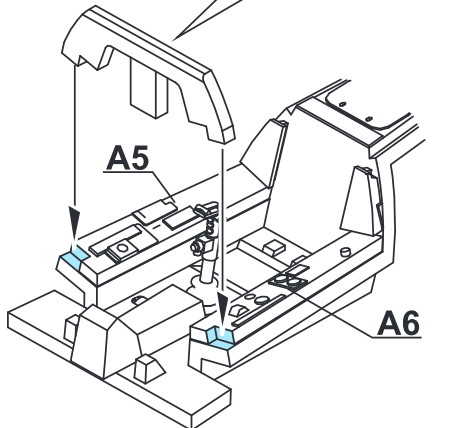
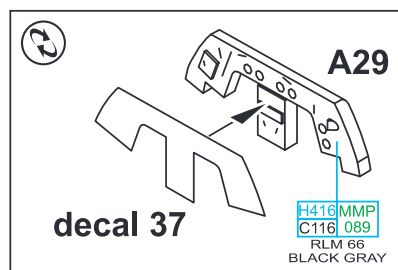
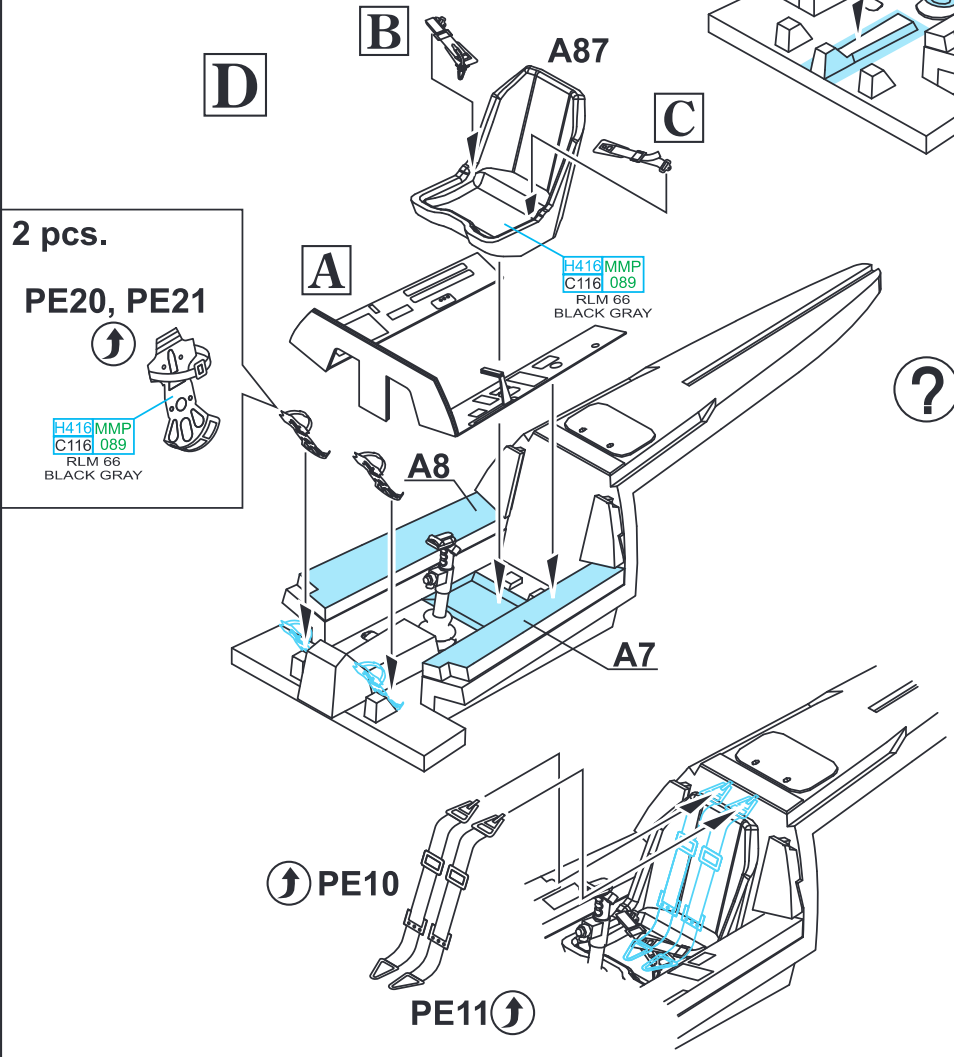
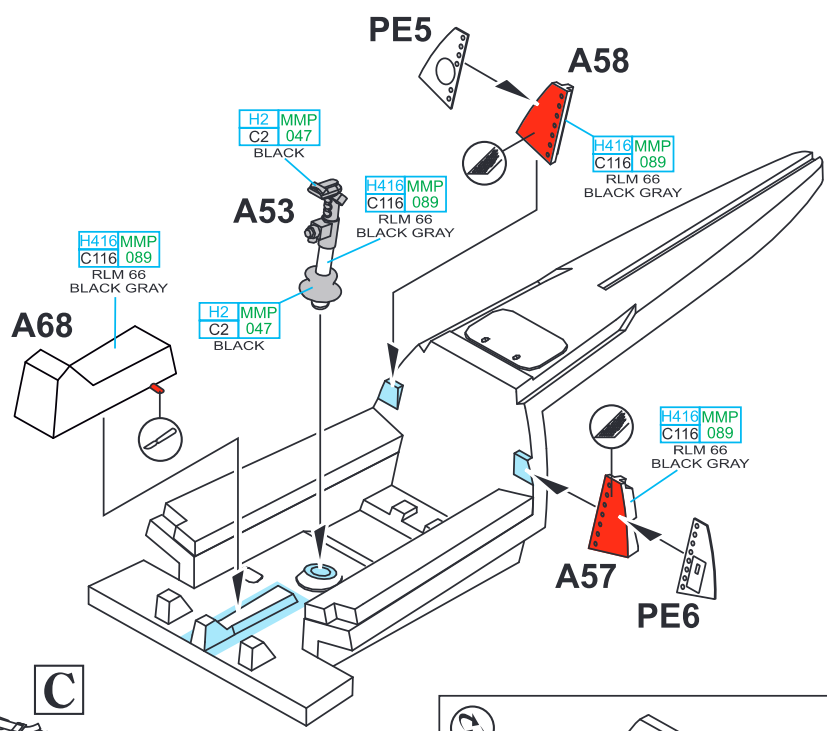
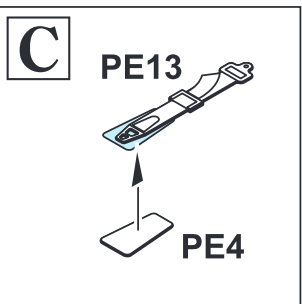
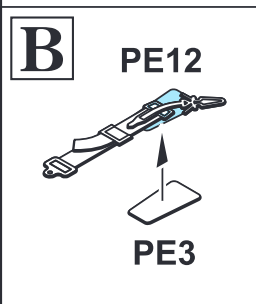
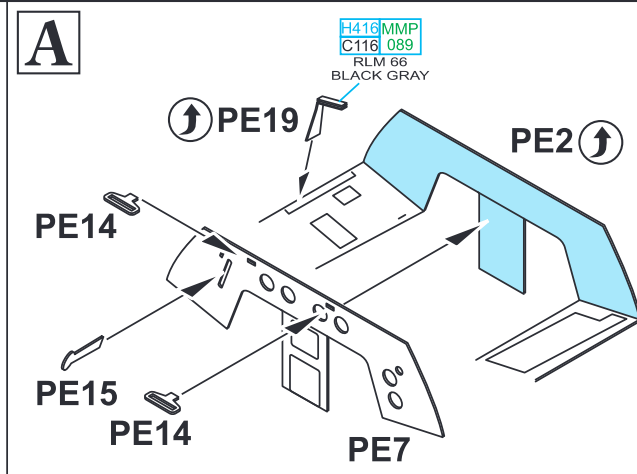
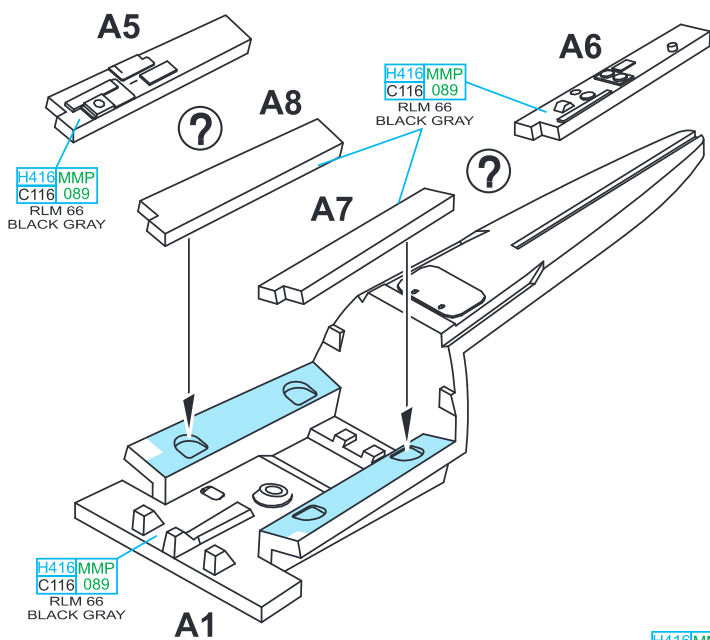

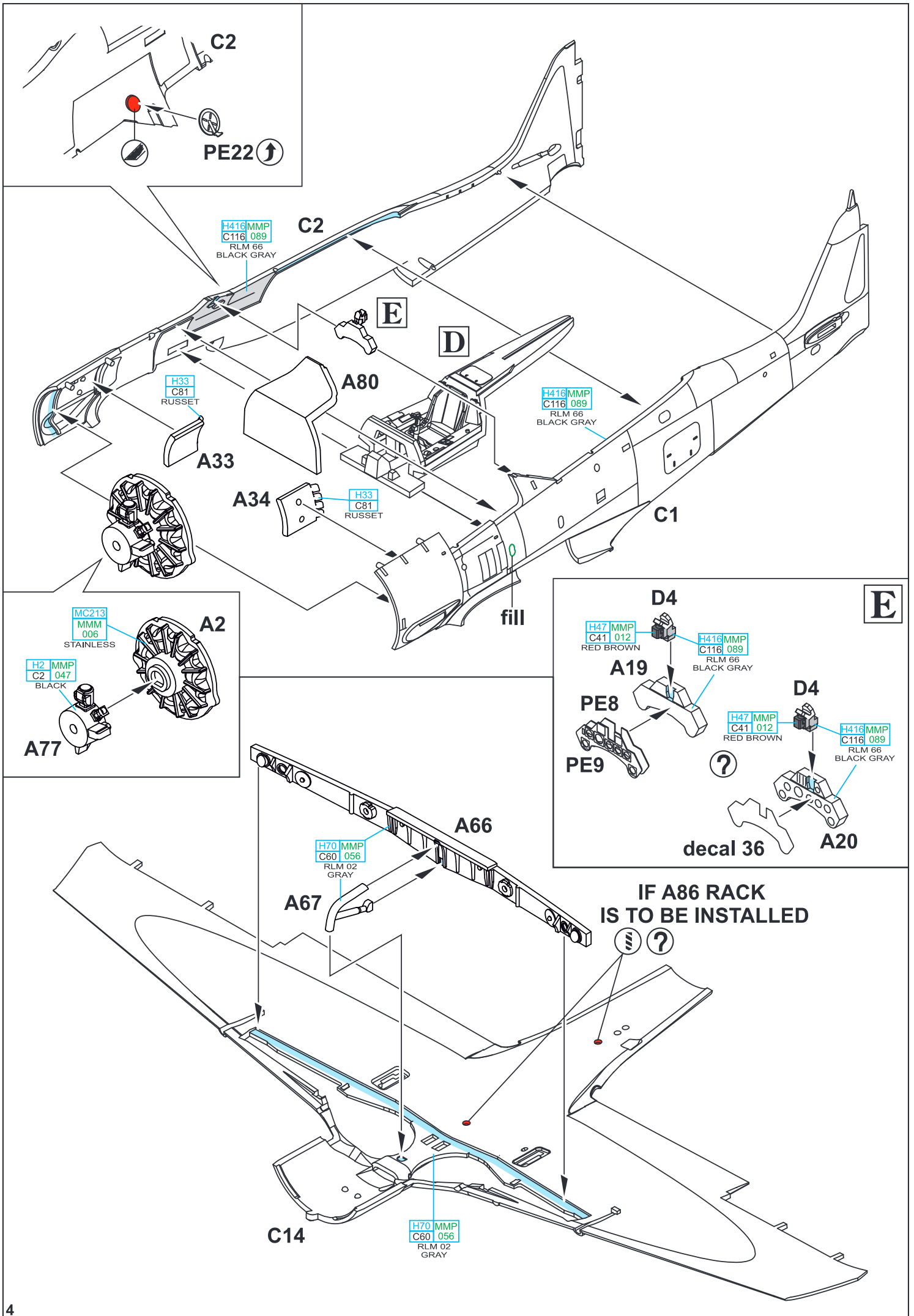

C2

PE22 ↻

H416 MMP
C116 089
RLM 66
BLACK GRAY

C2

E

D

H33
C81
RUSSET

A33

A34

H33
C81
RUSSET

H416 MMP
C116 089
RLM 66
BLACK GRAY

C1

fill

E

MC213
MMM
006
STAINLESS

A2

H2 MMP
C2 047
BLACK

A77

D4

H47 MMP
C41 012
RED BROWN

H416 MMP
C116 089
RLM 66
BLACK GRAY

A19

PE8

PE9

H47 MMP
C41 012
RED BROWN

?

H416 MMP
C116 089
RLM 66
BLACK GRAY

A20

decals 36

A66

H70 MMP
C60 056
RLM 02
GRAY

A67

IF A86 RACK
IS TO BE INSTALLED

⋮ ?

C14

H70 MMP
C60 056
RLM 02
GRAY

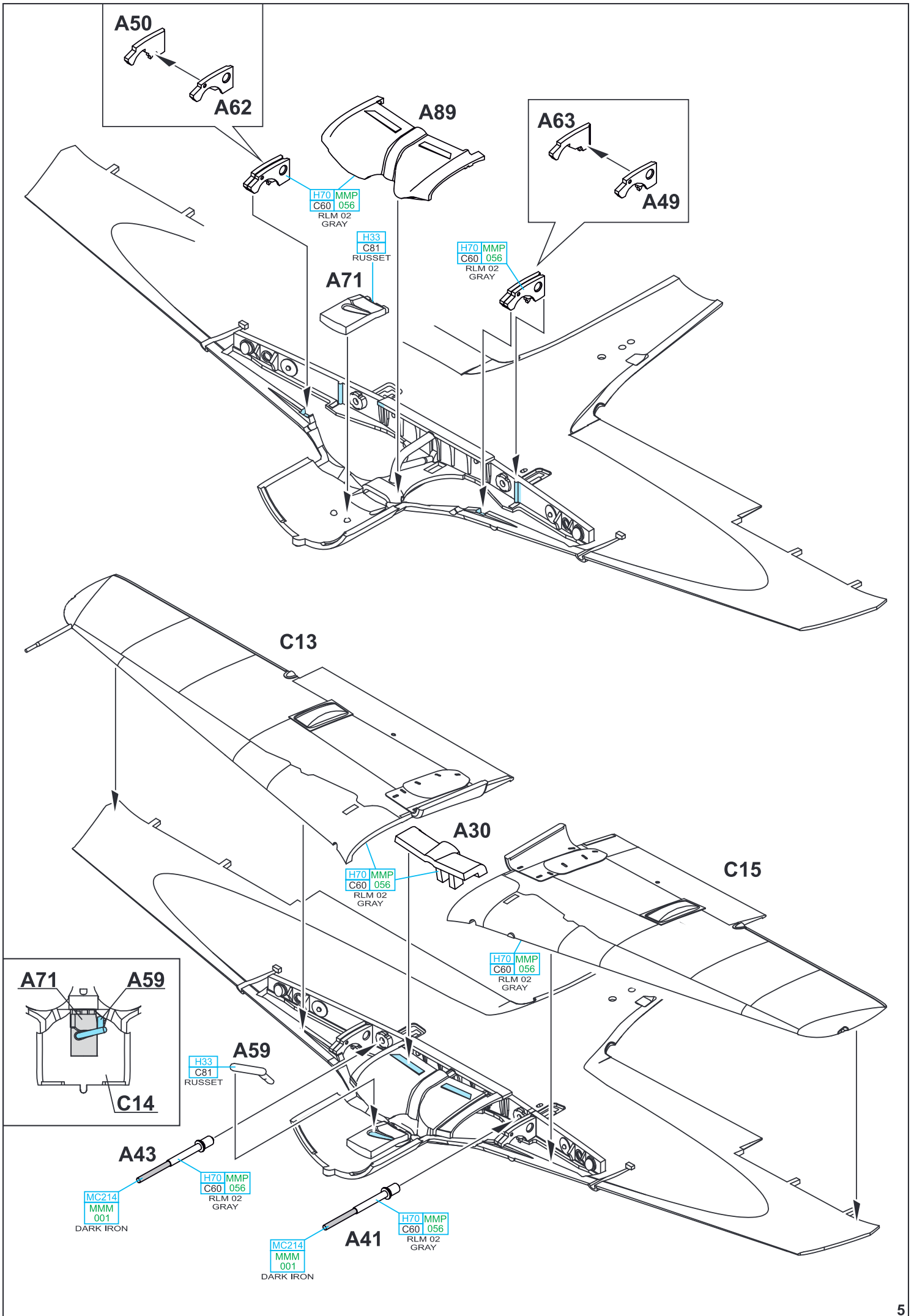

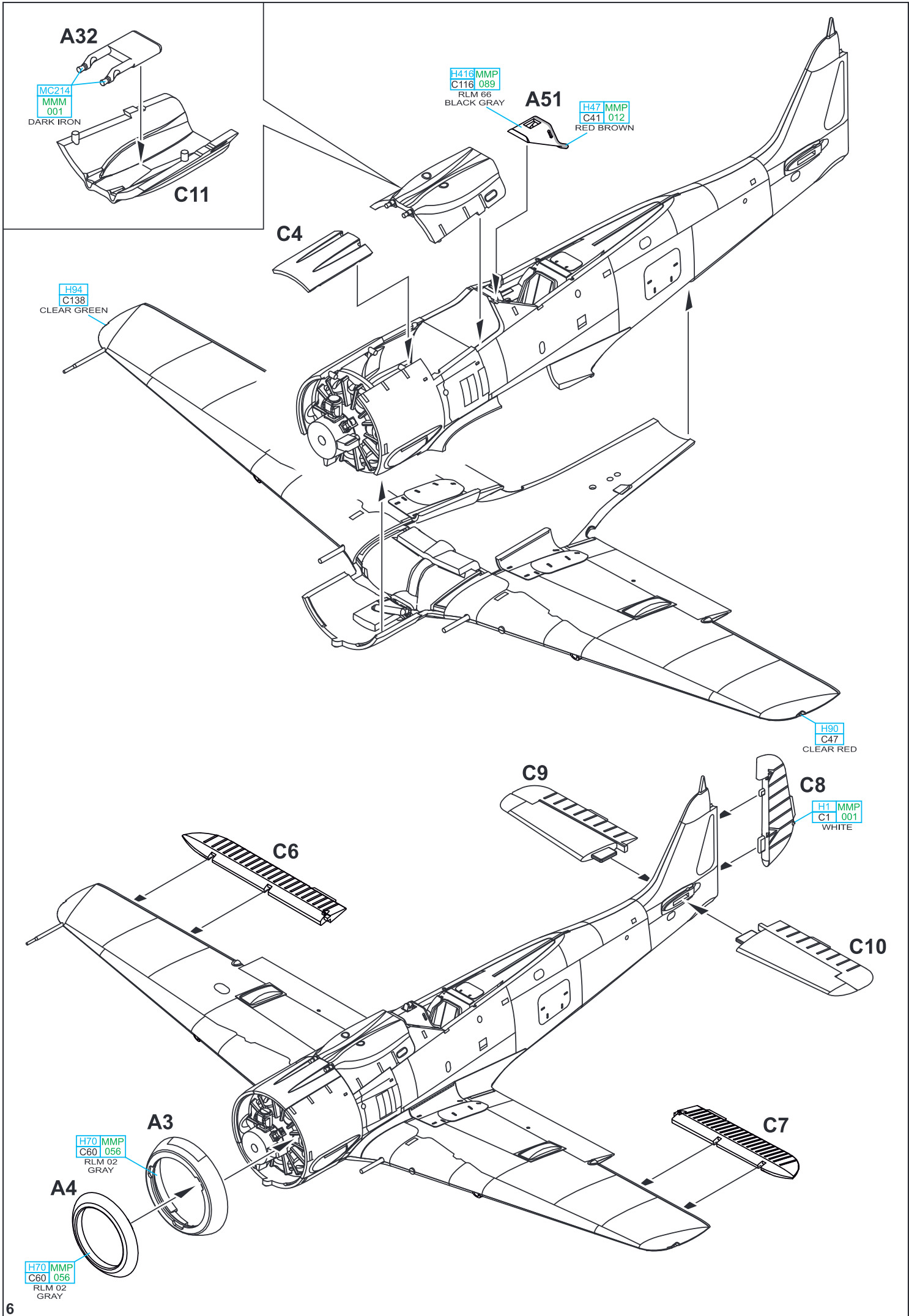

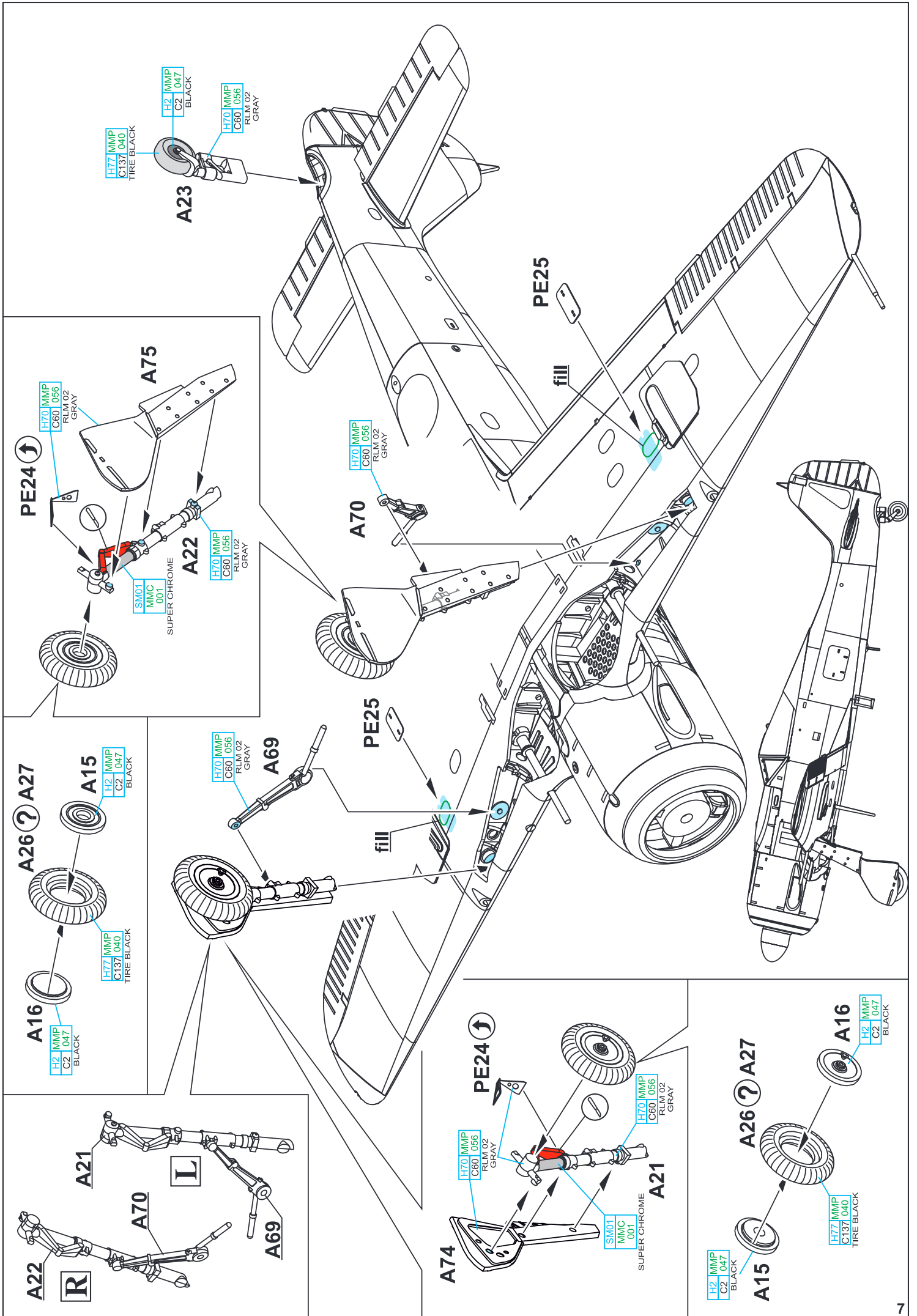

H77 MMP
C137 040
TIRE BLACK

A23

H2 MMP
C2 047
BLACK

H70 MMP
C60 056
RLM 02
GRAY

PE24 ↻

A75

H70 MMP
C60 056
RLM 02
GRAY

SM01
MMC
001
SUPER CHROME

A22

H70 MMP
C60 056
RLM 02
GRAY

H70 MMP
C60 056
RLM 02
GRAY

A70

PE25

fill

A26 Ⓣ A27

A15

H2 MMP
C2 047
BLACK

H70 MMP
C60 056
RLM 02
GRAY

A69

PE25

fill

A16

H2 MMP
C2 047
BLACK

H77 MMP
C137 040
TIRE BLACK

A74

PE24 ↻

A21

H70 MMP
C60 056
RLM 02
GRAY

H70 MMP
C60 056
RLM 02
GRAY

A21

SM01
MMC
001
SUPER CHROME

A22

R

A21

A70

A69

H2 MMP
C2 047
BLACK

A15

A26 Ⓣ A27

A16

H2 MMP
C2 047
BLACK

H77 MMP
C137 040
TIRE BLACK

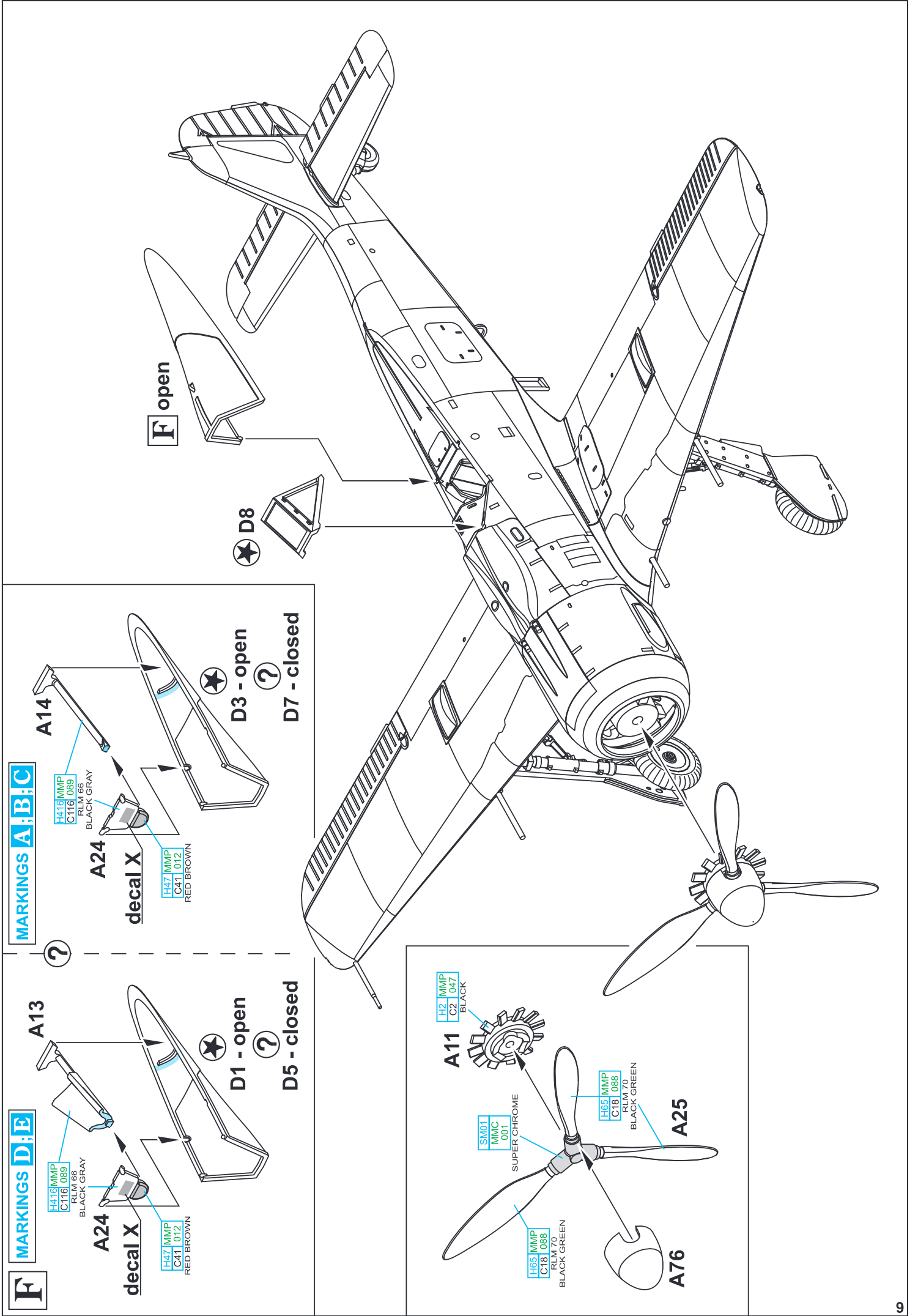

F

MARKINGS D, E

MARKINGS A, B, C

A13

H416 MMP
C116 089
RLM 66
BLACK GRAY

A24

decal X

H47 MMP
C41 012
RED BROWN

D1 - open

D5 - closed

A14

H416 MMP
C116 089
RLM 66
BLACK GRAY

A24

decal X

H47 MMP
C41 012
RED BROWN

D3 - open

D7 - closed

D8

F open

A11

H2 MMP
C2 047
BLACK

SM01
MMC
001
SUPER CHROME

A25

H65 MMP
C18 088
RLM 70
BLACK GREEN

A76

H65 MMP
C18 088
RLM 70
BLACK GREEN

70111

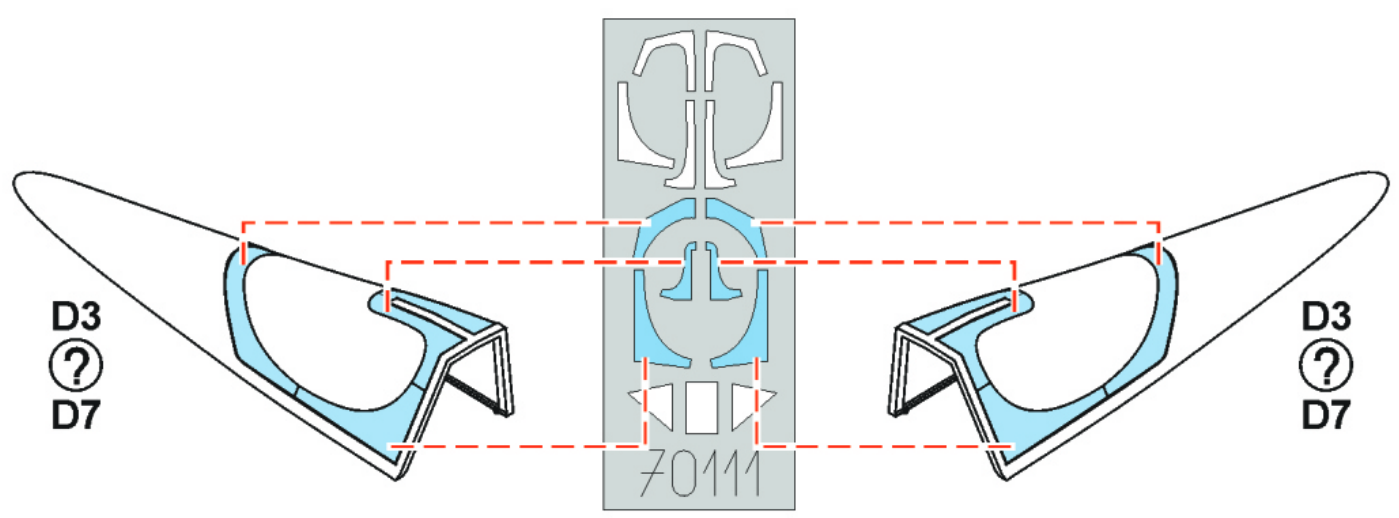
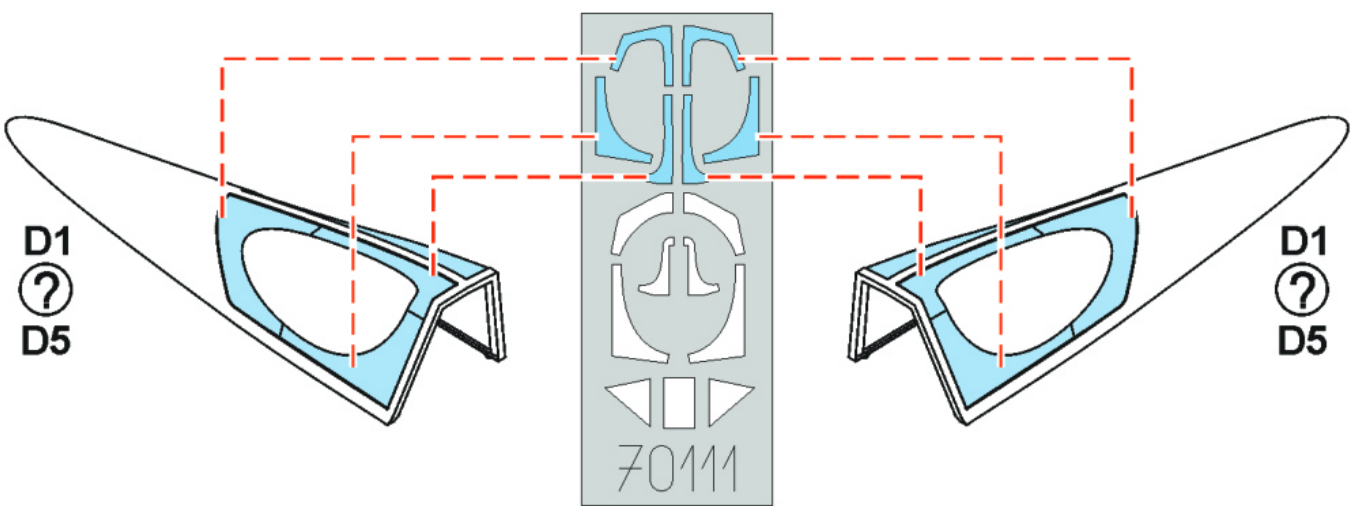
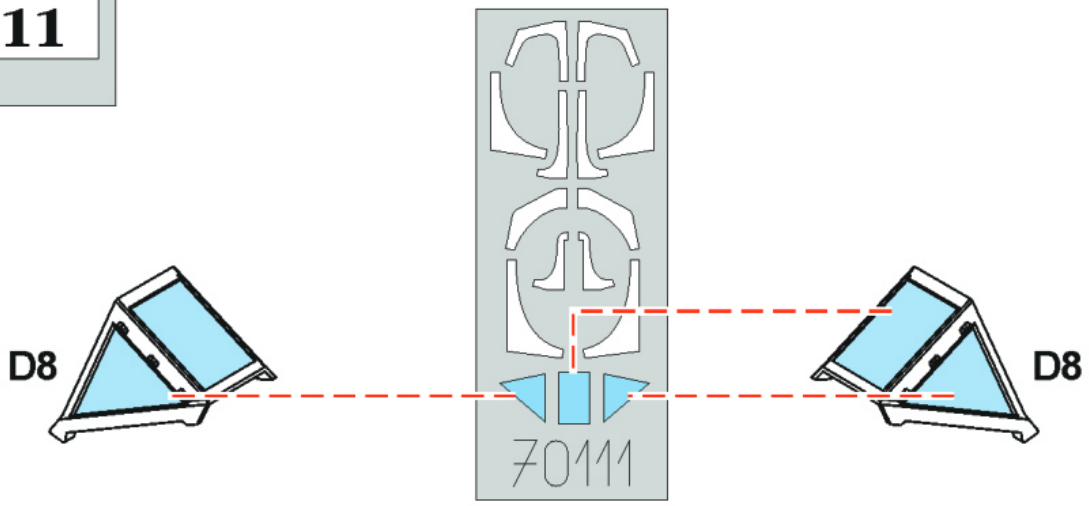

A IV./JG 5, Herdla, Norway, Spring 1945

Blue '8' with the name 'Erika' below the cockpit, was one of several Fw 190A-8 that 12./JG 5 abandoned at Herdla in Norway after disbanding in the spring of 1945. The aircraft carried RLM 74/75/76 camouflage with a blue cowl ring and spinner denoting its Staffel. The applied Adlerflugel behind the exhausts was for the noted time period uncommon. The JG 5 insignia 'Eismeer' on the engine cowl was applied only on the port side. The aircraft number was repeated on the wheel hub. IV./JG 5 took part in the defence of northern sector of occupied Europe, but was not standardized within the Defence of the Reich system.

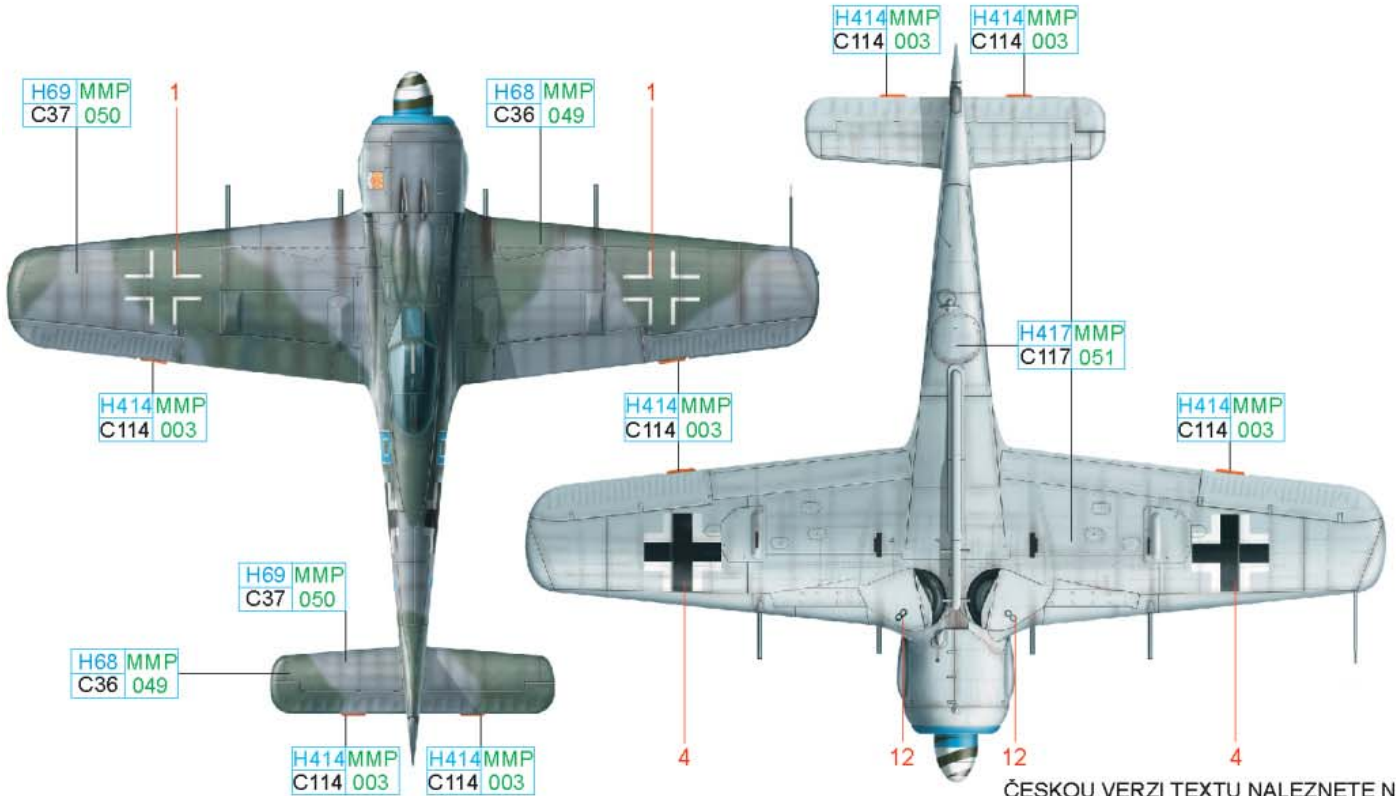
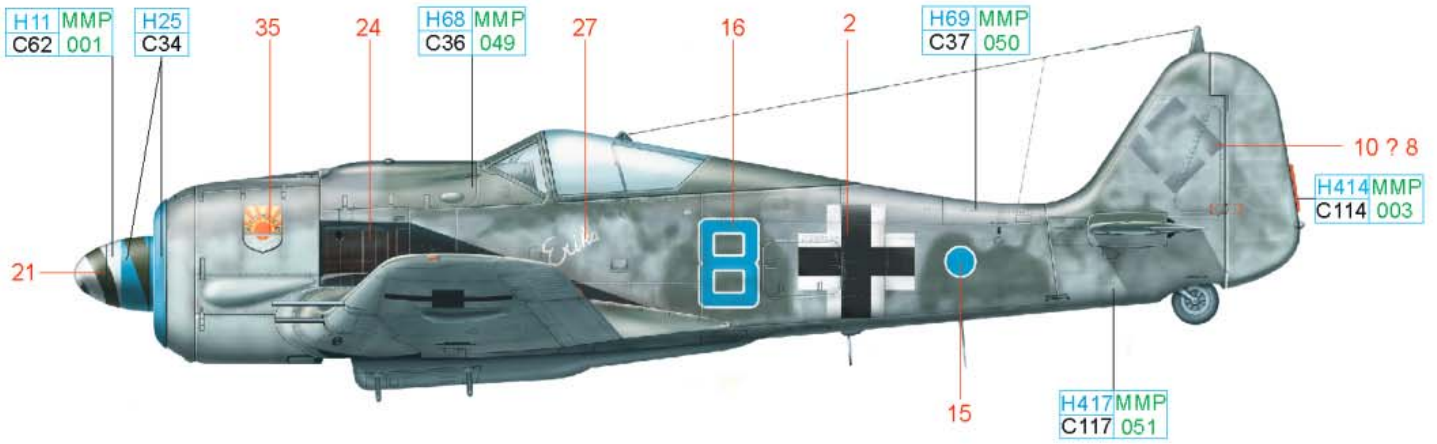

ČESKOU VERZI TEXTU NALEZNETE NA www.eduard.cz POD KATALOGOVÝM ČÍSLEM 70111

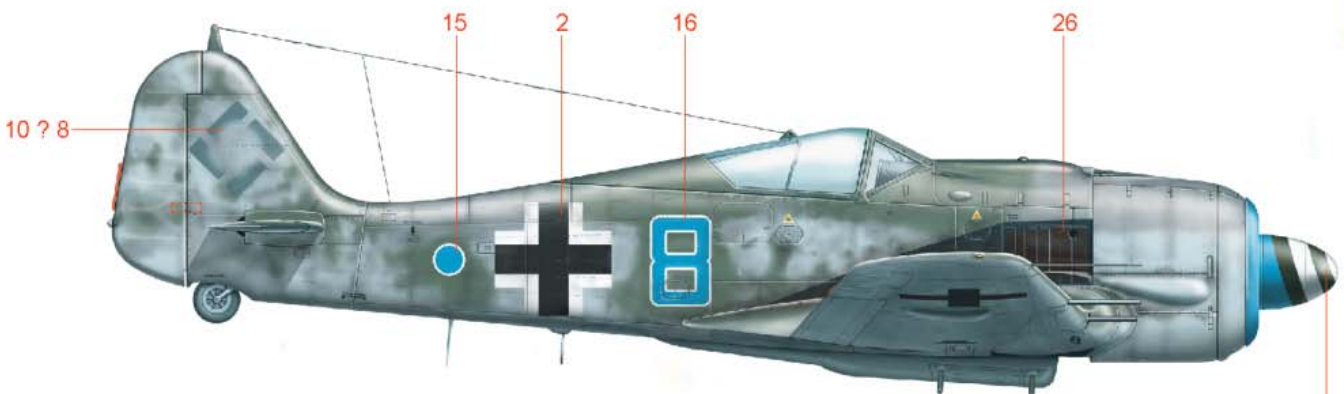

| | | | | | |
|--------|------------------|--------|------------------|----------|-----------------|
| WHITE | H11 MMP C62 001 | RLM 23 | H414MMP C114 003 | SKY BLUE | H25 C34 |
| RLM 76 | H417MMP C117 051 | RLM 75 | H69 MMP C37 050 | RLM 74 | H68 MMP C36 049 |

B Maj. Walter Dahl, Stab/JG 300, Jüterbog, Germany, December 1944

With the illustrated aircraft, the later of his two documented Blue '13's, Maj. Walter Dahl took part in combat operations in the Defence of the Reich in 1944, as Kommodore of JG 300. For a time, the plane carried the emblem of Stab JG 300, a B-17 silhouette in crosshairs. This emblem likely also appeared on the other side of the engine cowl. Although this was in all likelihood without a background, it has been speculated that this may also have been in a light blue color. The aircraft carries the standard camouflage of RLM 74/75/76 with obvious signs of repair and respraying. This may have included a yellow underside of the cowlings, which at this time was ordered to have been overpainted. The red identification band on the fuselage used in the ID system within the Defence of the Reich may have also been switched later to blue-white-blue.

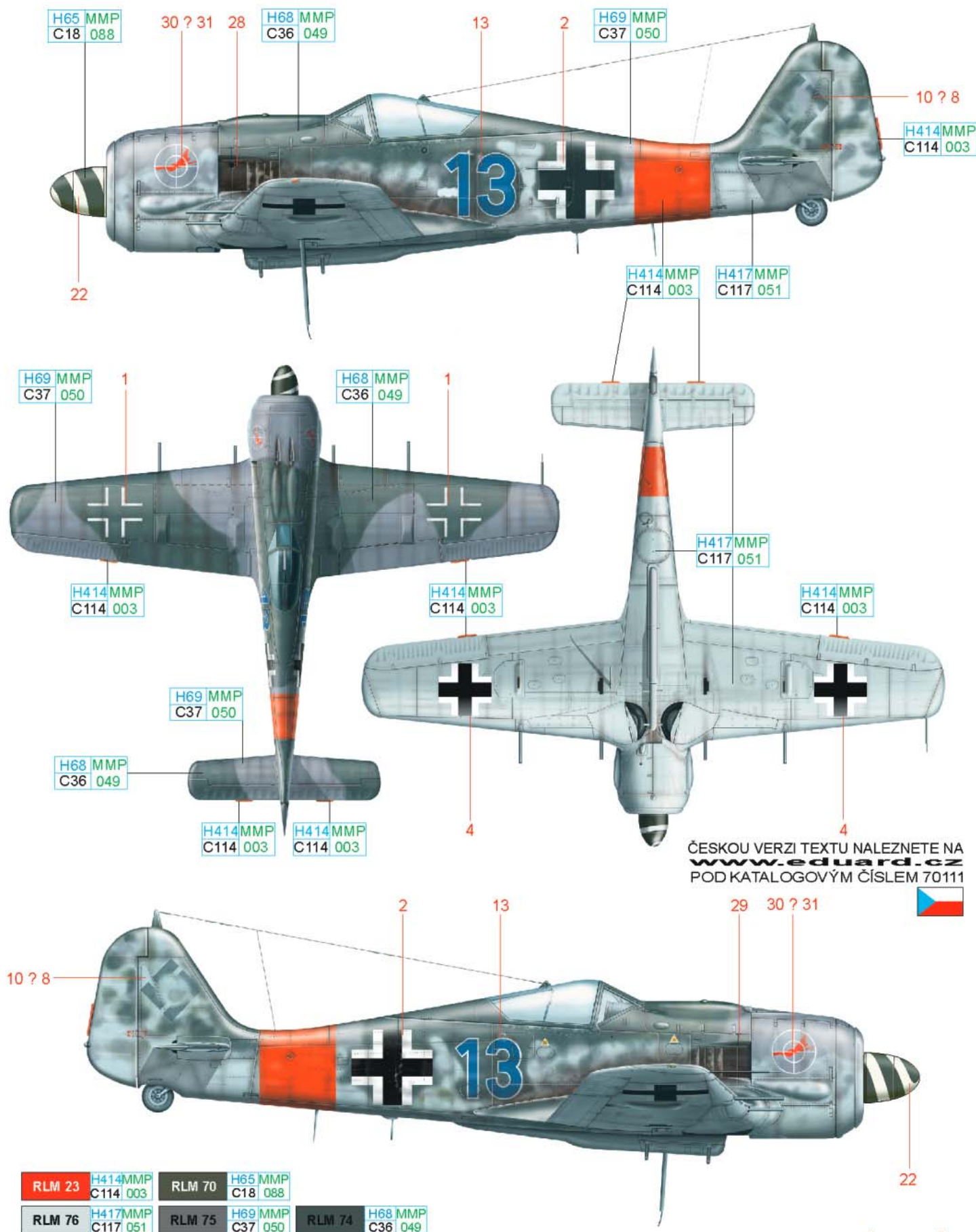

C Uffz. Julius Händel, IV./JG 54, Poland, August/September, 1944

Uffz. Julius Händel flew this very interestingly painted machine in the service of 13. (10.)/JG 54 on the collapsing Eastern Front. It carried a scheme of RLM 74/75/76 with a yellow prop hub, with the yellow extending to the propeller blades. The Indian emblem on the port side of the fuselage was an identifier for 13./JG 54. This aircraft didn't carry the IV. Gruppe marking on the rear fuselage, and has been documented without a fuselage rack. In September 1944, IV./JG 54 stood down for R and R time at Illersheim, but soon entered combat operations against the Allies when Uffz. Händel lost his life in a dogfight with USAAF Thunderbolts on September 23th, 1944 over Kleve/Nijmegen. Two days later, he was awarded the Iron Cross, Second Class...

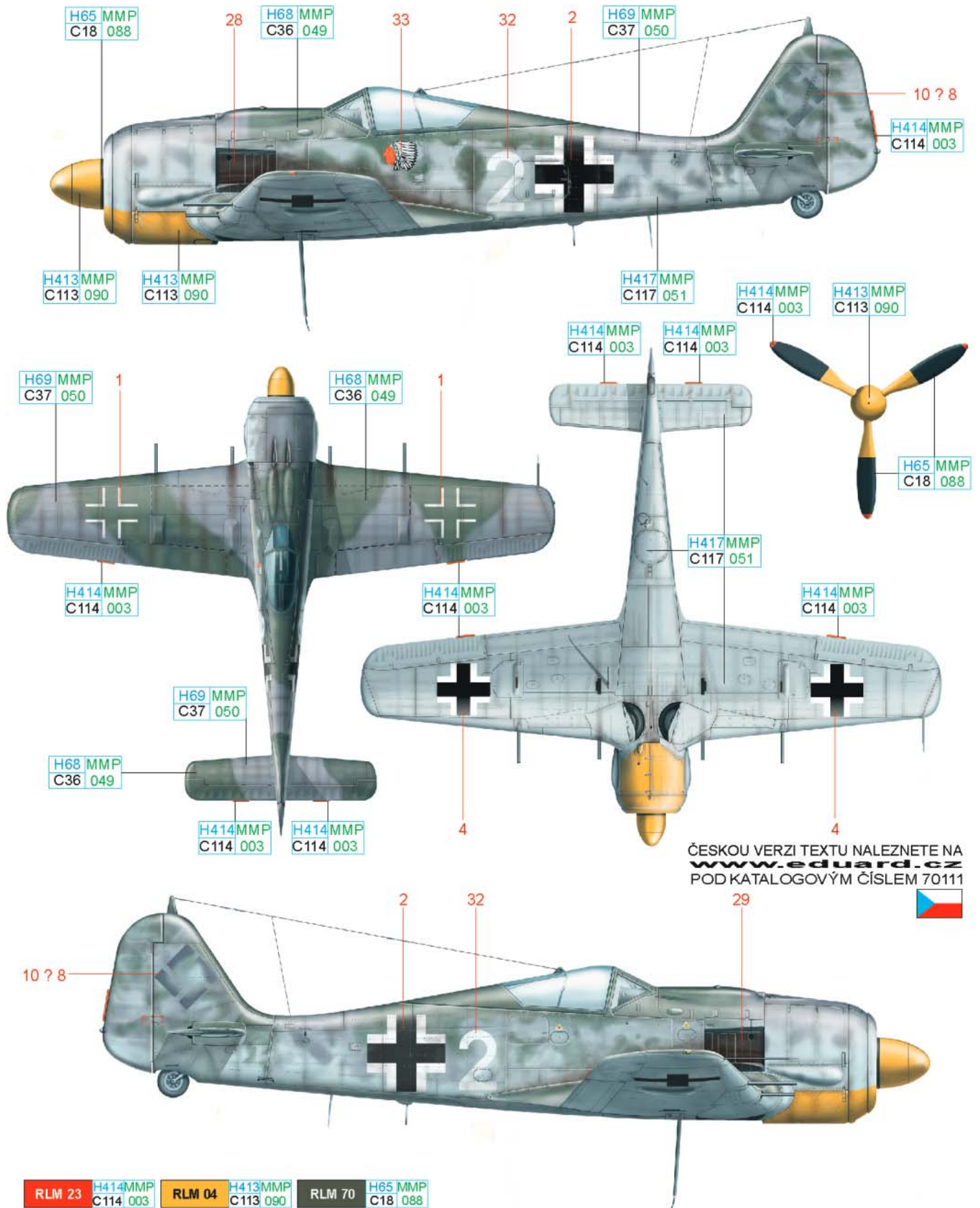

ČESKOU VERZI TEXTU NALEZNETE NA
www.eduard.cz
 POD KATALOGOVÝM ČÍSLEM 70111



| | | | | | |
|--------|---------------------|--------|---------------------|--------|--------------------|
| RLM 23 | H414MMP C114 003 | RLM 04 | H413MMP C113 090 | RLM 70 | H65 MMP C18 088 |
| RLM 76 | H417MMP C117 051 | RLM 75 | H69 MMP C37 050 | RLM 74 | H68 MMP C36 049 |

D Lt. Gustav Salfner, 7./JG 300, Lobnitz, Germany, March 1945

White '6', flown by the CO of 7./JG 300, carried the typical camouflage pattern from the closing months of the war. The top surfaces of the fuselage was sprayed RLM 83 that carried over to the side fuselage color, RLM 76. The top of the wings were covered with RLM 75/83 (perhaps 81/83). JG 300 ID markings in their later form, composed of blue-white-blue rear fuselage stripes, were carried. The emblem consisting of a unicorn on a red background was a simplified insignia of Salfner's family. Munich's Gustav Salfner ended the war with an Iron Cross Second Class and seven confirmed and seven probable victories.

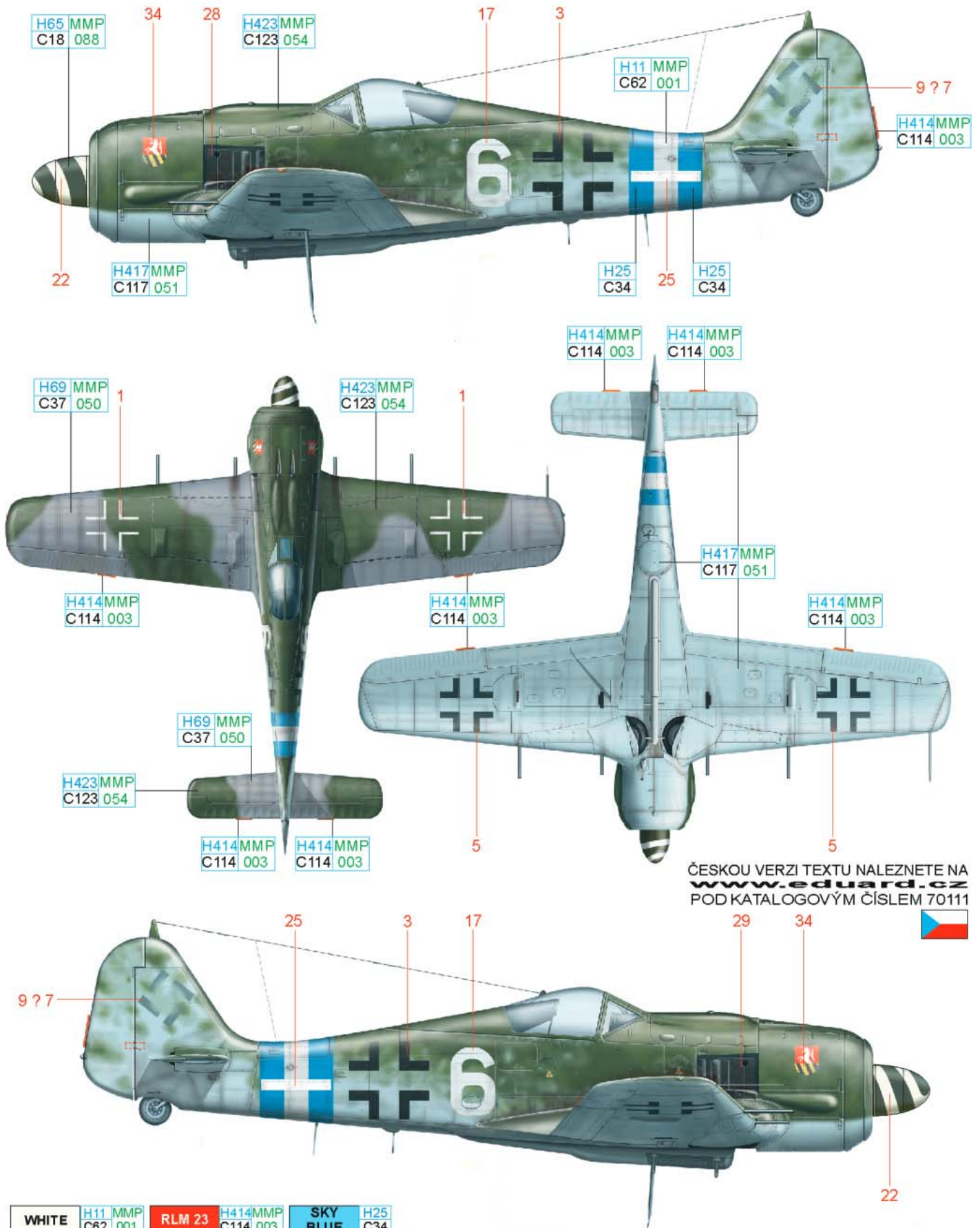

ČESKOU VERZI TEXTU NALEZNETE NA www.eduard.cz POD KATALOGOVÝM ČÍSLEM 70111

| | | | | | |
|--------|---------------------|--------|---------------------|----------|---------------------|
| WHITE | H11 MMP C62 001 | RLM 23 | H414MMP C114 003 | SKY BLUE | H25 C34 |
| RLM 76 | H417MMP C117 051 | RLM 75 | H69 MMP C37 050 | RLM 70 | H65 MMP C18 088 |
| | | | | RLM 83 | H423MMP C123 054 |

E W.Nr 380352, I./JG 11, Darmstadt, Germany, Spring 1945

This reconstruction of the aircraft discovered at Darmstadt after the end of the war shows off the late war scheme of RLM 81/83/84. The fuselage side below the cockpit carries the black and white emblem of JG 11 'Der Wächter'. The yellow band denoting service with JG 11 within the Defence of the Reich is complemented by the yellow tail surface tips.

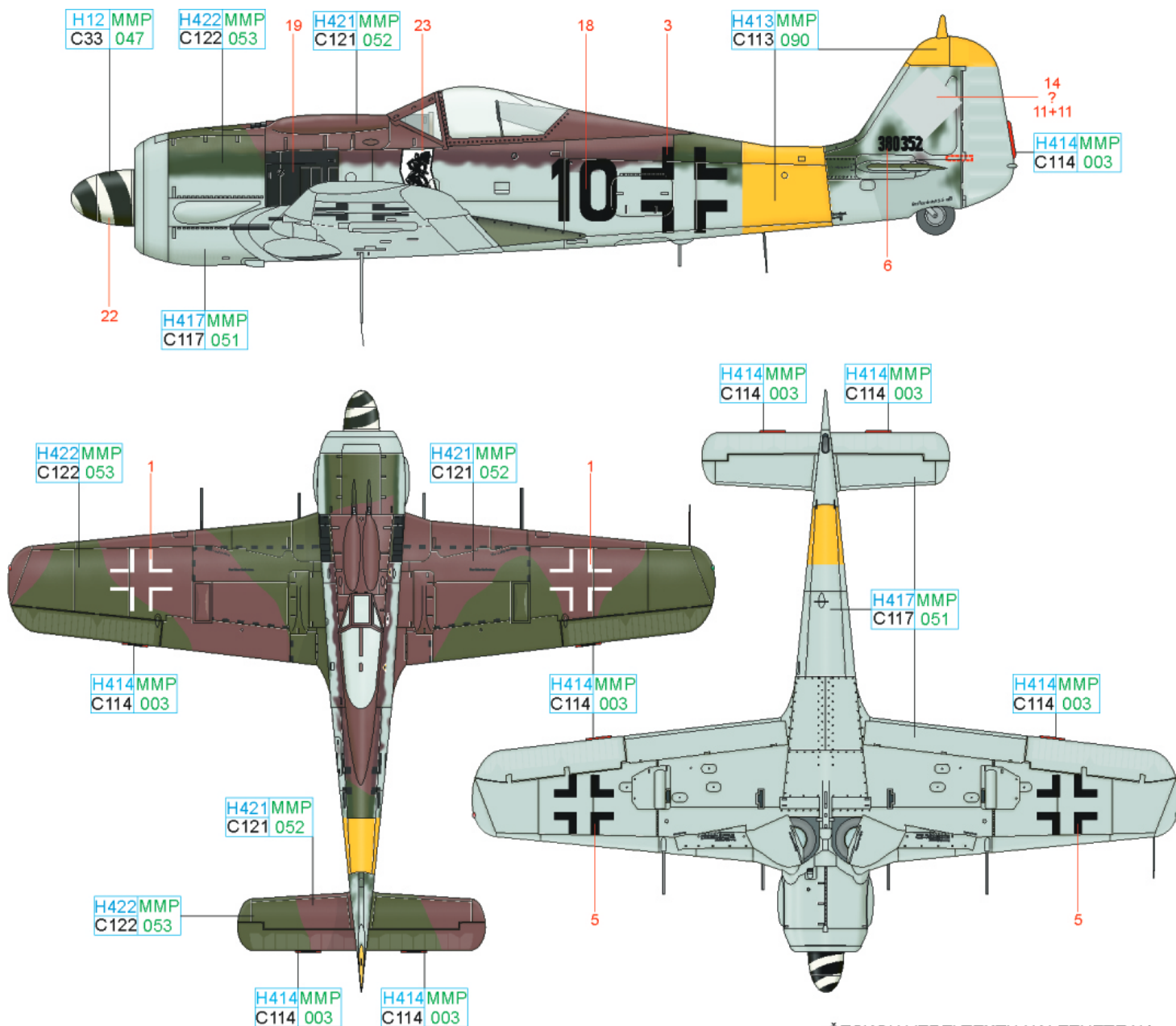

ČESKOU VERZI TEXTU NALEZNETE NA
www.eduard.cz
 POD KATALOGOVÝM ČÍSLEM 70111

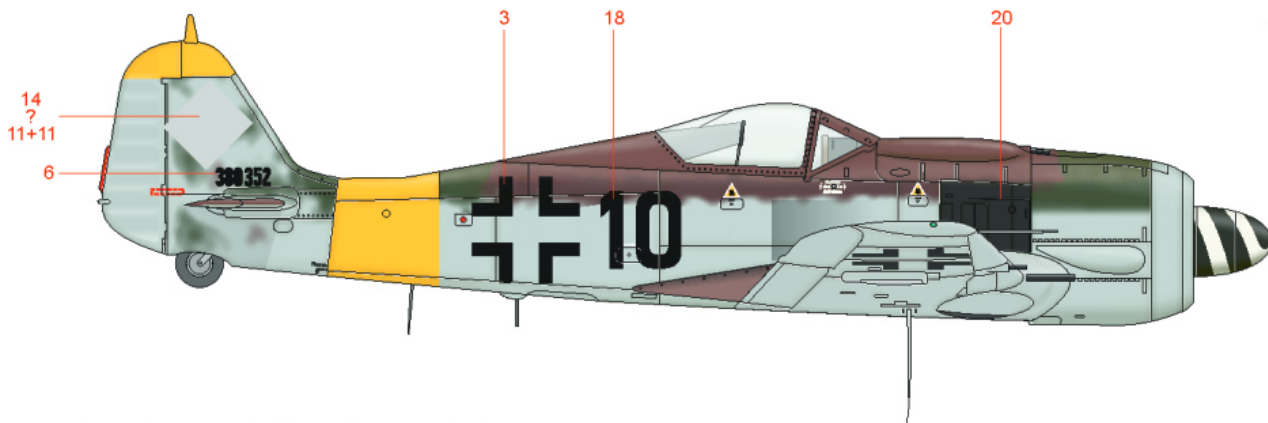

| | | | | | |
|--------|----------------------|--------|----------------------|--------|----------------------|
| RLM 23 | H414 MMP C114 003 | RLM 04 | H413 MMP C113 090 | BLACK | H12 MMP C33 047 |
| RLM 76 | H417 MMP C117 051 | RLM 81 | H421 MMP C121 052 | RLM 82 | H422 MMP C122 053 |

